

Panasonic®

Personal Computer

Model No. **CF-19** series

Operating Instructions - Basic Guide

Getting Started

Introduction	2
Description of Parts	4
First-time Operation	7
Turning On / Turning Off	12

Getting Started

Useful Information

Handling and Maintenance	13
Installing Software	15

Useful Information

Troubleshooting

Troubleshooting (Basic)	19
-------------------------------	----

Troubleshooting

Appendix

LIMITED USE LICENSE AGREEMENT	24
Specifications	25

Appendix

Introduction







Thank you for purchasing this Panasonic product. For optimum performance and safety, please read these instructions carefully.

In these instructions, the names are referred as follows.

Windows 8.1 indicates Windows® 8.1 Operating System.

Windows 7 indicates Windows® 7 Operating System.

■ Terms and illustrations in these instructions

CAUTION :	Conditions that may result in minor or moderate injury.
NOTE :	Useful and helpful information.
Enter :	Press [Enter] key.
Fn + F5 :	Press and hold [Fn] key, and then press [F5] key.
Windows 8.1	
• Display “Charm”:	Align the pointer to the top right (or bottom right) corner of the screen to display Charm menu. Alternatively, flick toward the center of the screen from the right edge or press and hold Ⓢ (Enter) button.
•  -  :	Click  (Settings) and then click  (Power).
Windows 7	
 (Start) - [All Programs] :	Click  (Start), and then click [All Programs]. You may need to double-click in some cases.
→ :	Page in these Operating Instructions or in the Reference Manual.
 :	Reference to the on-screen manuals.

- Some illustrations are simplified to help your understanding and may look different from the actual unit.
- If you do not log on as an administrator, you cannot use some functions or cannot display some screens.
- Refer for the latest information about optional products to the catalogs, etc.
- In these instructions, the names and terms are referred as follows.
 - “Windows® 8.1 Pro 64-bit” as “Windows” or “Windows 8.1”
 - “Windows® 7 Professional 32-bit Service Pack 1” and “Windows® 7 Professional 64-bit Service Pack 1” as “Windows” or “Windows 7”
 - DVD MULTI drive as “CD/DVD drive”
 - Circular media including DVD-ROM and CD-ROM as “discs”
- **Windows 8.1**
Screen messages are explained in [English (United States)].
(Depending on the language preference, some screen messages in these instructions are different from the actual screen messages. For example, [Flight mode] may be displayed instead of [Airplane mode] in some language preference.)

■ Disclaimer

Computer specifications and manuals are subject to change without notice. Panasonic Corporation assumes no liability for damage incurred directly or indirectly from errors, omissions or discrepancies between the computer and the manuals.

■ Trademarks

Microsoft®, Windows®, and the Windows logo are registered trademarks of Microsoft Corporation of the United States and/or other countries.

Intel, Core and PROSet are either registered trademarks or trademarks of Intel Corporation.

SDXC Logo is a trademark of SD-3C, LLC.



Adobe, the Adobe logo and Adobe Reader are either registered trademarks or trademarks of Adobe Systems Incorporated in the United States and/or other countries.

Bluetooth® is a registered trademark owned by Bluetooth SIG, Inc., U.S.A. and licensed to Panasonic Corporation. Names of products, brands, etc., appearing in this manual are trademarks or registered trademarks of their respective own companies.

■ On-screen Manual

For further information about the computer, you can refer to the on-screen manual.

- **Reference Manual**

The Reference Manual contains the practical information to help you fully enjoy the computer's performance.

- **Important Battery Tips**

The Important Battery Tips will provide you with the battery information so that you can use the battery in the optimum condition to obtain longer operation time.

To access the on-screen manuals, follow the steps below.

Windows 8.1

On the Start screen, click the [Manual Selector] tile, and select the on-screen manual.

Windows 7

Double-click [Manual Selector] on the desktop, and select the on-screen manual.

NOTE

- [Contents] tab or [Search] tab is displayed on the left side of the window.
Select tab and display the desired item.
-

Description of Parts

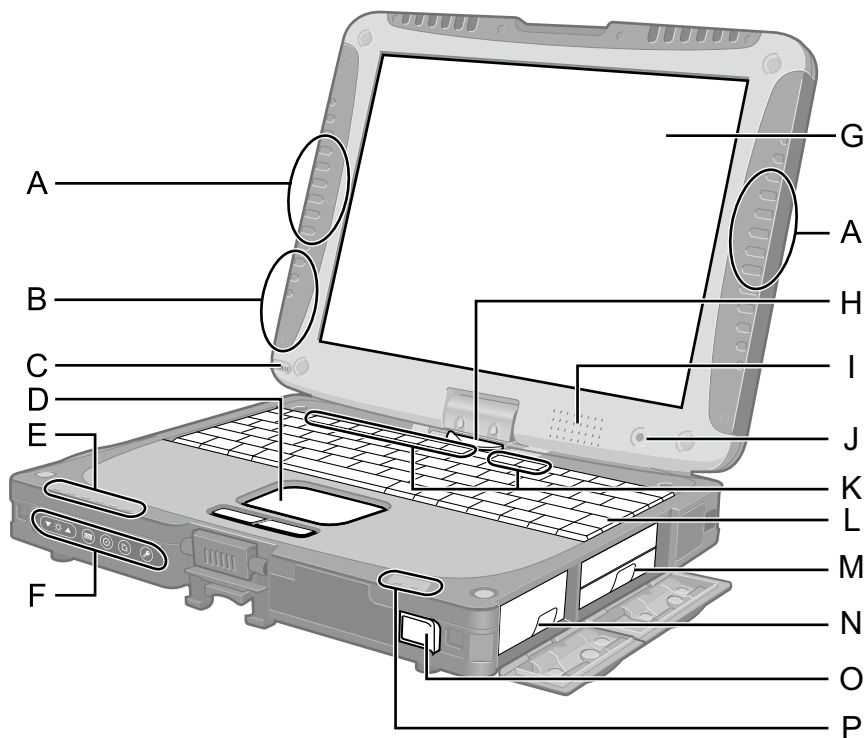

A: Wireless LAN Antenna

<Only for model with wireless LAN>

→ *Reference Manual* "Wireless LAN"

The wireless LAN switch may turn off depending on the reception.

B: Bluetooth Antenna

<Only for model with Bluetooth>

→ *Reference Manual* "Bluetooth"

C: Stylus Holder

D: Touch Pad

E: LED Indicator

✂ : Wireless ready

This indicator lights when Wireless LAN, Bluetooth are connected and ready. It does not necessarily indicate the On/Off condition of the wireless connection.

→ *Reference Manual* "Disabling/Enabling Wireless Communication"

Ⓐ : Caps lock

Ⓛ : Numeric key (NumLk)

Ⓜ : Scroll lock (ScrLk)

Ⓝ : Drive indicator

F: Tablet Buttons

→ *Reference Manual* "Tablet Buttons"

G: LCD

→ *Reference Manual* "Screen Input Operation"

H: Display Release Latch

→ page 6 "Switching to the Tablet mode"

I: Speaker

→ *Reference Manual* "Key Combinations"

J: Ambient Light Sensor

Backlight will be turned off with a bright environment so the battery operation time becomes long. It doesn't function when concealing.

→ *Reference Manual* "Setup Utility"

K: Function Key

→ *Reference Manual* "Key Combinations"

L: Keyboard

M: Hard Disk Drive

→ *Reference Manual* "Hard Disk Drive"

N: Battery Pack

Specified Battery pack: CF-VZSU48U

O: Power Switch

P: LED Indicator

Ⓟ : Battery status

→ *Reference Manual* "Battery Power"

Ⓢ : Power status

(Off: Power off/Hibernation, Green: Power on, Blinking orange and green: Sleep, Blinking green rapidly: Cannot power on or resume due to low temperature.)

Left side

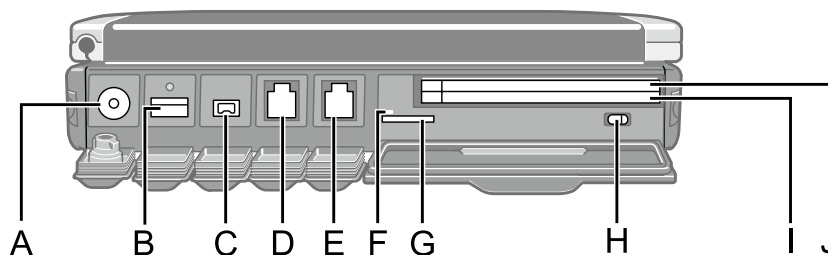

Rear side

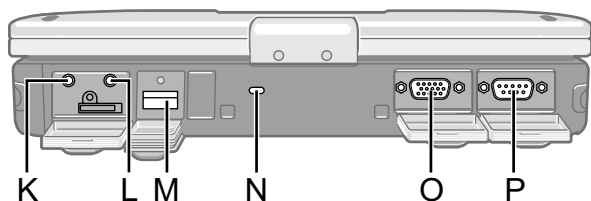

Bottom

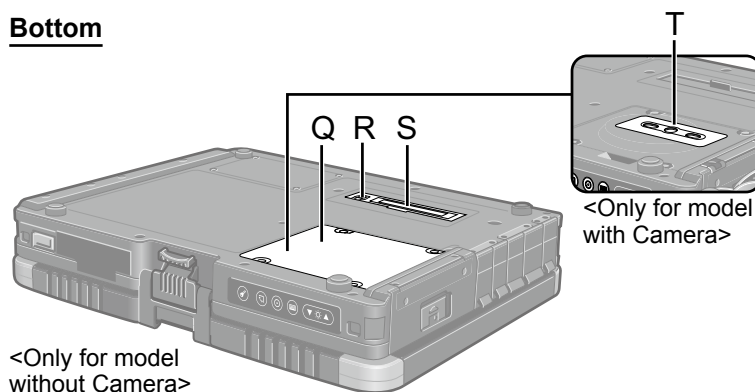

A: DC-IN Jack

B: USB Port (3.0)

→ *Reference Manual "USB Devices"*

C: IEEE 1394 Interface Connector

→ *Reference Manual "IEEE 1394 Devices"*

D: Modem Port

→ *Reference Manual "Modem"*

E: LAN Port

→ *Reference Manual "LAN"*

F: SD Memory Card Indicator

(Blinking: During access)

→ *Reference Manual "SD Memory Card"*

G: SD Memory Card Slot

Keep SD Memory Cards Away from Infants and Small Children.

→ *Reference Manual "SD Memory Card"*

H: Wireless Switch

→ *Reference Manual "Disabling/Enabling Wireless Communication"*

I: <For model without Smart Card Slot>

PC Card Slot (PC)

→ *Reference Manual "PC Card / ExpressCard"*

<For model with Smart Card Slot>

Smart Card Slot (SCR)

→ *Reference Manual "Smart Card"*

J: <For model without Smart Card Slot>

ExpressCard Slot (EX)

→ *Reference Manual "PC Card / ExpressCard"*

<For model with Smart Card Slot>

PC Card Slot (PC)

→ *Reference Manual "PC Card / ExpressCard"*

K: Headphone Jack

You can connect headphones or amplified speakers. When they are connected, audio from the internal speakers is not heard.

L: Microphone Jack

A condenser microphone can be used. If other types of microphones are used, audio input may not be possible, or malfunctions may occur as a result.

M: USB Port (2.0)

→ *Reference Manual "USB Devices"*

N: Security Lock

A Kensington cable can be connected.

For further information, read the manual that comes with the cable.

O: External Display Port (VGA)

→ *Reference Manual "External Display"*

P: Serial Port

Q: RAM Module Slot

<For model without Camera>

→ *Reference Manual "RAM Module"*

R: External Antenna Connector

S: Expansion Bus Connector^{*1}

→ *Reference Manual "Port Replicator / Car Mounter"*

T: Camera

<For model with Camera>

Remove the protection seal on the camera before using the camera.

^{*1} If you connect this computer to CF-VEB181 series or CF-WEB182 series, you cannot use a keyboard port.

Description of Parts

- This computer contains a magnet and magnetic products at the locations circled in the illustration at right. Avoid leaving metallic object or magnetic media in contact with these areas.

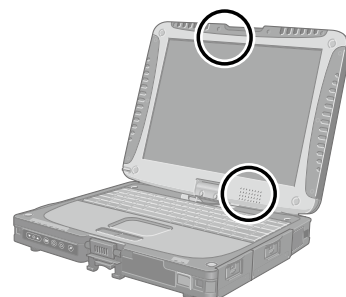

Switching to the Tablet mode

- ① Lift up the display so it stands perpendicular to the body.
- ② Slide the display release latch (A), and rotate the display clockwise until it clicks.

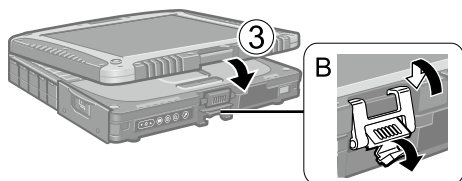
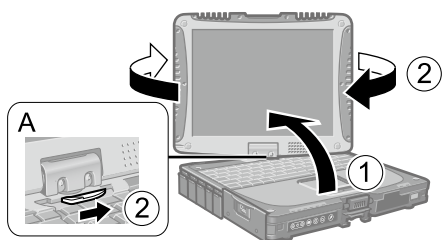

- ③ Close as the display faces up and fix it using the latch (B).

Attaching the hand strap and the shoulder strap (option)

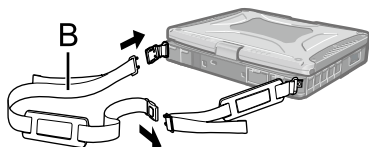
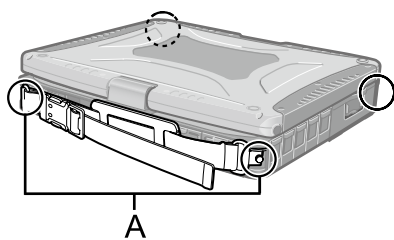

Attach the hand strap to any two of the corners (A) using the screws. You can connect the shoulder strap (B) to the hand strap. (The illustration is an example.)







CAUTION

- Do not use the strap to carry a heavier weight than the computer. Otherwise the strap may become loose by itself.
- Do not use the strap if it becomes worn or damaged.

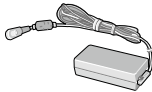
First-time Operation

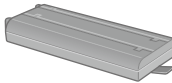
■ Preparation

- ① Check and identify the supplied accessories.
If you do not find the described accessories, contact Panasonic Technical Support.

• AC Adaptor. 1	• AC Cord 1	• Battery Pack ... 1	• Stylus ^{*2} 1
			
Model No: CF-AA5713A ^{*1}		Model No: CF-VZSU48U ^{*1}	Model No: CF-VNP003U
• Tether 1	• Soft Cloth 1		• USB Joint Cable ^{*3} 1
			

➔  Reference Manual “Screen Input Operation”

• OPERATING INSTRUCTIONS - Read Me First 1

^{*1} The model number will be different depending on the country. For the correct model number, contact Panasonic Technical Support.
^{*2} Stored in the pen holder at the time of packaging.
^{*3} Not included with some models. If it is not included, ask your system administrator.

- ② Read the LIMITED USE LICENSE AGREEMENT before breaking the seal on the computer’s packaging (➔ page 24).

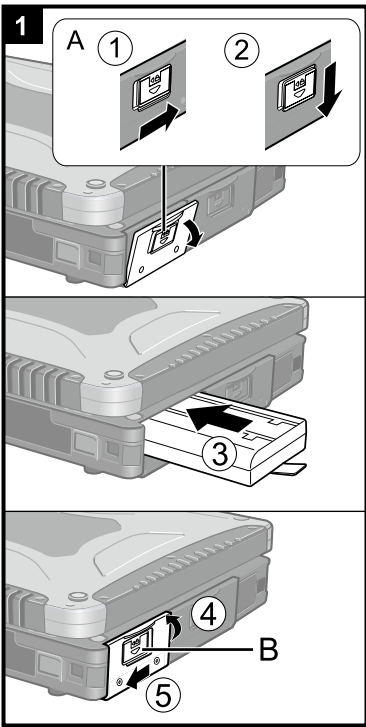

1 Inserting the Battery Pack

- ① Slide the latch (A) to the right to unlock the cover.
- ② Slide the latch (A) down, and open the cover.
- ③ Insert the battery pack until it securely fits the connector.
- ④ Close the cover.
- ⑤ Slide the latch (B) to the left to lock the cover.

CAUTION

- Make sure the latch is securely locked. Otherwise the battery pack may fall when you carry the computer.
- Do not touch the terminals of the battery pack and the computer. Doing so can make the terminals dirty or damaged, and may cause malfunction of the battery pack and the computer.

NOTE

- Note that the computer consumes electricity even when the computer power is off. If the battery pack is fully charged, the battery will fully discharge in the following period of time:
 - When power is off: Approx. 4 weeks
 - In sleep: Approx. 4 days
 - In hibernation: Approx. 2 weeks
- When the DC plug is not connected to the computer, disconnect the AC cord from your electrical outlet. Power is consumed simply by having the AC adaptor plugged into an electrical outlet.

First-time Operation

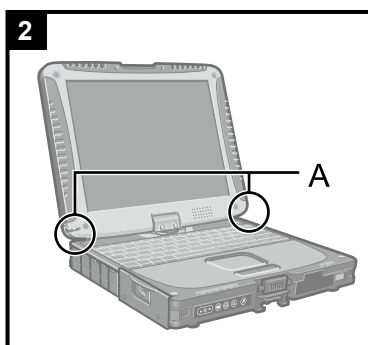

2 Attaching the stylus to the computer

Use the tether to attach the stylus to the computer so you will not lose it. There are holes (A) to attach it.

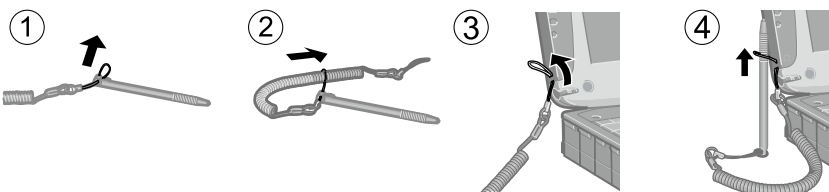

CAUTION

- Do not pull the tether with excessive force. The stylus may hit the computer, person's body or other objects when released.

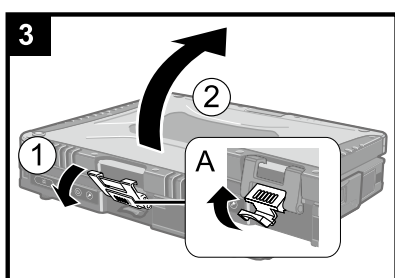

3 Opening the Display

- Pull up the part (A) and release the latch.
- Lift open the display.

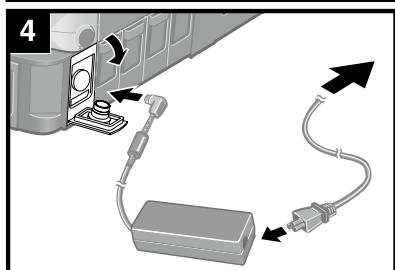

4 Connect your computer to a power outlet.

The battery charging starts automatically.

CAUTION

- Do not disconnect the AC adaptor and do not switch the wireless switch to on until the first-time operation procedure is completed.
- When using the computer for the first time, do not connect any peripheral device except the battery pack and AC adaptor.
- Handling the AC adaptor**
 - Problems such as sudden voltage drops may arise during periods of thunder and lightning. Since this could adversely affect your computer, an uninterruptible power source (UPS) is highly recommended unless running from the battery pack alone.

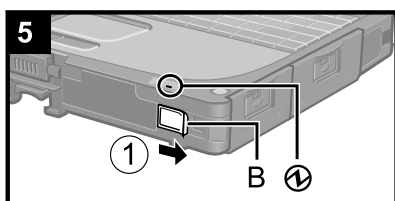

5 Turn on the computer.

- Slide and hold the power switch (B) until the power indicator ① lights.

CAUTION

- Do not slide the power switch repeatedly.
- The computer will forcibly be turned off if you slide and hold the power switch for four seconds or longer.
- Once you turn off the computer, wait for ten seconds or more before you turn on the computer again.
- Do not perform the following operation until the drive indicator (light) turns off.
 - Connecting or disconnecting the AC adaptor
 - Sliding the power switch
 - Touching the keyboard, touch pad, tablet buttons, touchscreen or external mouse
 - Closing the display
 - Turn on/off the wireless switch
- When the CPU temperature is high, the computer may not start up to prevent overheating of the CPU. Wait until the computer cools down, and then turn the power on again. If the computer does not power on even after cooling down, contact Panasonic Technical Support.
- Any changes from the default setting of the Setup Utility must not be made until the First-time Operation is completed.

6

Windows 7

Select language and OS (32-bit or 64-bit).**CAUTION**

- Carefully choose your language because you cannot change it later. If you set a wrong language, you need to reinstall Windows.

- ① Select language and OS (32bit or 64bit) and click [OK].
The language setting will start by clicking [OK] on the confirmation screen.
You can return to the “Select OS” screen by clicking [Cancel].
The language and OS setting will be completed in about 15 minutes.
- ② When termination screen is displayed, click [OK] to turn off the computer.

7

Setup Windows.

Windows 8.1

Select language and click [Next].

Windows 7

Turn on the computer.

Follow the on-screen instructions.

- The computer restarts several times. Do not touch the keyboard or touch pad, and wait until the drive indicator  has turned off.
- After the computer is turned on, the screen remains black or unchanged for a while, but this is not a malfunction. Wait for a moment until the Windows setup screen appears.
- During setup of Windows, use the touch pad and clicking to move the pointer and to click an item.
- Setup of Windows will take approximately **Windows 8.1** 5 minutes / **Windows 7** 20 minutes.
Go to the next step, confirming each message on the display.
- You can set the Wireless Network after the setup of Windows is complete.
Windows 8.1 If “Get online” is displayed, select “Skip this step”.
Windows 7 “Join a wireless network” screen may not appear.
- **Windows 8.1** Verify the time zone, date and time.

CAUTION

- You can change the user name, password, image and security setting after setup of Windows.
- Remember your password. If you forget the password, you cannot use Windows. Creating a password reset disk beforehand is recommended.
- Do not use the following words and characters for user name: CON, PRN, AUX, CLOCK\$, NUL, COM1 to COM9, LPT1 to LPT9, @, &, space. In particular, if you create a user name (account name) that includes the “@” mark, a password will be requested at the log-on screen, even if no password has been set.
If you try to log on without entering a password, “The user name or password is incorrect.” may be displayed and you will not be able to **Windows 8.1** sign in / **Windows 7** log on to Windows (→ page 21).
- Use standard characters as a computer name: numbers 0 through 9, uppercase and lowercase letters from A to Z, and the hyphen (-) character.
If the error message “The computer name is not valid” appears, check if characters other than the above are not entered. If the error message still remains on the display, set the key entry mode to English (“EN”) and enter characters.
- When setting up the keyboard, choose the appropriate one to your computer. Otherwise, input by the keyboard may become unavailable.

8

Create the recovery disc.

A recovery disc allows you to install OS and restore its factory default condition, in case, for example, the recovery partition of the HDD is damaged.

We recommend creating a recovery disc before you begin using the computer. Refer to  *Reference Manual* “Recovery Disc Creation Utility” about creating the disc.

First-time Operation

NOTE

● PC Information Viewer

This computer periodically records the management information of the hard disk, etc. The maximum data volume for each record is 1024 bytes.

This information is only used for estimating the cause when the hard disk goes down by any possibility. They are never sent to outside via network nor used for any other purpose except for the purpose described the above.

To disable the function, add the check mark for [Disable the automatic save function for management information history] in [Hard Disk Status] of PC Information Viewer, and click [OK].

(→  *Reference Manual* “Checking the Computer’s Usage Status”)

- **Windows 8.1** In the default settings, a shortcut icon for Korean language is on the Desktop screen. You may delete the icon if not necessary.
- **Windows 7** If the recovery partition is deleted, you cannot create Recovery Disc(s).

■ Before using wireless function

- ① Slide the wireless switch to ON.

Windows 8.1

- ② Display “Charm” and click  - [Change PC Settings] - [Network] - [Airplane mode].
Set [Wi-Fi] to [On] (for wireless LAN).
set [Bluetooth] to [On] (for Bluetooth).
set [GPS\GNSS] to [On] (for GPS).

■ To change the partition structure

You can shrink a part of an existing partition to create unallocated disk space, from which you can create a new partition.

In the default setting, you can use a single partition.

- ① **Windows 8.1**

Right-click  at the bottom left corner of the Desktop screen.

Windows 7

Click  (Start) and right-click [Computer], then click [Manage].

- A standard user needs to enter an administrator password.



- ② Click [Disk Management].
- ③ Right-click the partition for Windows (“c” drive in the default setting), and click [Shrink Volume].
 - The partition size depends on the computer specifications.
- ④ Input the size in [Enter the amount of space to shrink in MB] and click [Shrink].
 - You cannot input a larger number than the displayed size.
 - To select [Reinstall to the OS related partitions.] in installing OS (→ page 16), 70 GB or more is necessary for [Total size after shrink in MB].
- ⑤ Right-click [Unallocated] (the shrunk space in the step ④) and click [New Simple Volume].
- ⑥ Follow the on-screen instructions to make the settings, and click [Finish].
Wait until formatting is completed.

NOTE

- You can create an additional partition using remaining unallocated space or newly creating unallocated space.
- To delete a partition, right-click the partition and click [Delete Volume] in the step ③.

■ **Windows 8.1** To select language

To select a language other than the one you have selected during the first-time operation, follow the steps below.

- ① Perform either of the following procedures.
 - Right-click  at the bottom left corner of the Desktop screen.
 - Click  on the Start screen.
- ② Click [Control Panel].
- ③ Click [Clock, Language, and Region] - [Language] - [Add a language].
- ④ Select a language, and then click [Add].

Depending on the region, two or more languages are selectable. Click [Open] and select the desired language, and then click [Add].
- ⑤ Click [Option] for the language you want to use.
- ⑥ Click [Make this the primary language].

NOTE

- If [Make this the primary language] is not displayed, you cannot change to this language. Follow the on-screen instructions.

-
- ⑦ Click [Log off now].
 - ⑧ Sign in to the Windows.

Turning On / Turning Off

Turning On

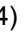
Slide and hold the power switch  (→ page 4) until the power indicator  (→ page 4) lights.



NOTE

- Do not slide the power switch repeatedly.
- The computer will forcibly be turned off if you slide and hold the power switch for four seconds or longer.
- Once you turn off the computer, wait for ten seconds or more before you turn on the computer again.
- Do not perform the following operation until the drive indicator  turns off.
 - Connecting or disconnecting the AC adaptor
 - Sliding the power switch
 - Touching the keyboard, touch pad, tablet buttons, screen or external mouse
 - Closing the display
 - Turn on/off the wireless switch

Turning Off

Windows 8.1

You can shut down the computer by using either of the following steps.

- From the Start screen:
 - ① Click  - [Shut down].
- From the Desktop screen:
 - ① Right-click  at the bottom left corner of the Desktop screen.
 - ② Click [Shut down or sign out] - [Shut down].

Windows 7

- ① Click  (Start) - [Shutdown].

NOTE

- **Windows 8.1**
To turn off the computer completely, proceed as follows.
 - ① Display "Charm" and click  - [Change PC settings] - [Update and recovery] - [Recovery].
 - ② Click [Restart now] under "Advanced startup"
 - ③ Click [Turn off your PC].

Precautions against Starting Up/Shutting Down

- Do not do the following
 - Connecting or disconnecting the AC adaptor
 - Sliding the power switch
 - Touching the keyboard, touch pad, screen or external mouse
 - Closing the display
 - Turn on/off the wireless switch

NOTE

- To conserve power, the following power saving methods are set at the time of purchase.
 - The screen automatically turns off after :
 - 10 minutes (when AC adaptor is connected) of inactivity
 - 5 minutes (when operating on battery power) of inactivity
 - The computer automatically enters sleep^{*1} after :
 - 20 minutes (when AC adaptor is connected) of inactivity
 - 15 minutes (when operating on battery power) of inactivity

^{*1} Refer to  *Reference Manual* "Sleep or Hibernation Functions" about resuming from sleep.

Handling and Maintenance

Operation environment

- Place the computer on a flat stable surface not subject to shock, vibration, and danger of dropping. Do not place the computer upright or turn it over. If the computer is exposed to an extremely strong impact, it may become damaged.
- Operating environment
 - Temperature: Operation : -10 °C to 50 °C (IEC60068-2-1, 2)^{*1}
Storage : -20 °C to 60 °C
 - Humidity: Operation : 30% to 80% RH (No condensation)
Storage : 30% to 90% RH (No condensation)Even within the above temperature/humidity ranges, operation for a long time in extreme environments, smoking nearby, or operation in places where oil is used or where there is a lot of dust will result in the product deterioration and will shorten the product life.
- ^{*1} Do not expose the skin to this product when using the product in a hot or cold environment. (→ OPERATING INSTRUCTIONS - Read Me First)
If the computer is wet in temperatures of 0 °C or below, freeze damage may occur. Make sure to dry off the computer in such temperatures.
- Do not place the computer in the following areas, otherwise the computer may be damaged.
 - Near electronic equipment. Image distortion or noise may occur.
 - In extremely high or low temperature.
- As the computer can become hot during operation, keep it away from items that are sensitive to heat.

Handling cautions

This computer is designed to minimize shock to parts such as the LCD and the hard disk drive and equipped with a drip-proof keyboard, but no warranty is provided against any trouble caused by shock. Be extremely careful when handling the computer.

- When carrying the computer:
 - Turn off the computer.
 - Remove all external devices, cables, PC Cards and other protruding objects.
 - Do not drop or hit the computer against solid objects.
 - Do not leave the display open.
 - Do not grip the display part.
- Do not put anything (e.g., a piece of paper) between the display and keyboard.
- When you board an airplane, take the computer with you and never put it in your checked luggage. When using the computer on airplane, follow the airline's instructions.
- When carrying a spare battery, put it in a plastic bag to protect its terminals.
- The touch pad is designed to be used by a finger tip. Do not place any object on its surface and do not press down strongly with sharp-pointed or hard objects that may leave marks (e.g., nails, pencils and ball point pens).
- Avoid any harmful substances such as oil from getting into the touch pad. The pointer may not work correctly.
- Be careful not to get injured by dropping or getting hit when carrying the computer.
- Use only the included stylus to touch the touchscreen. Do not place any object on its surface and do not press down strongly with sharp-pointed or hard objects that may leave marks (e.g., nails, pencils and ball point pens).
- Do not use the touchscreen when dust or dirt (e.g., oil) is on the screen. Otherwise foreign particles on the screen/stylus can scratch the screen surface or obstruct the stylus operation.
- Use the stylus only for touching the screen. Using it for any other purpose may damage the stylus and result in scratches on the screen.

■ When using peripheral devices

Follow these instructions and the Reference Manual to avoid any damage to the devices. Carefully read the instruction manuals of the peripheral devices.

- Use the peripheral devices conforming to the computer's specifications.
- Connect to the connectors in the correct direction.
- If it is hard to insert, do not try forcibly but check the connector's shape, direction, alignment of pins, etc.
- If screws are included, fasten them securely.
- Remove the cables when you carry the computer. Do not pull the cables forcibly.

■ Preventing your computer from unauthorized use via wireless LAN/Bluetooth

<Only for model with wireless LAN/Bluetooth>

- Before using wireless LAN/Bluetooth, make the appropriate security settings such as data encryption.

Handling and Maintenance

■ Battery Recalibration

- The battery recalibration may take a long time due to the large battery capacity. This is not a malfunction.
<When performing “Battery Recalibration” after shutting down Windows>
 - Full charge: Approximately 3.5 hours
 - Complete discharge: Approximately 4.0 hoursWhen performing “Battery Recalibration” without shutting down Windows, it may take more time to charge / discharge.

Maintenance

To clean the LCD panel

If drops of water or other stains get on the surface of the LCD panel, wipe them off immediately. Failure to do so may result in staining.

Use the soft cloth included with the computer. (For further information, refer to “Suggestions About Cleaning the LCD Surface” →  *Reference Manual* “Screen Input Operation”.)

To clean areas other than the LCD panel

Wipe with a soft dry cloth such as gauze. When using detergent, dip a soft cloth in water-diluted detergent and wring it thoroughly.

CAUTION



- Do not use benzene, thinner, or rubbing alcohol since it may adversely affect the surface causing discoloration, etc. Do not use commercially-available household cleaners and cosmetics, as they may contain components harmful to the surface.
- Do not apply water or detergent directly to the computer, since liquid may enter inside of the computer and cause malfunction or damage.

Installing Software

Installing software will return the computer to the default condition. When you install the software, the hard disk data will be erased.

Back up important data to other media or an external hard disk before installation.

CAUTION

- Do not delete the Recovery Partition on the hard disk. The disk space in the partition is not available to store data. To check the Recovery Partition, perform the following methods.
 - ① **Windows 8.1**
Right-click  at the bottom left corner of the Desktop screen.
 - Windows 7**
Click  (Start) and right-click [Computer], then click [Manage].
 - A standard user needs to enter an administrator password.
 - ② Click [Disk Management].

■ **Windows 8.1** Remove everything and reinstall Windows

Preparation

- Remove all peripherals.
- Connect the AC adaptor and do not remove it until installation is complete.

1 Perform “Remove everything and reinstall Windows”.

- ① Display “Charm” and click  - [Change PC settings] - [Update and recovery] - [Recovery].
- ② Click [Get Started] under “Remove everything and reinstall Windows”.
- ③ Click [Next].
- ④ Select the option.
 - Just remove my files
Perform the reinstallation of the Windows in a few moments (Approximately 20 minutes).
 - Fully clean the drive
By fully cleaning, the deleted files can not be recovered easily and the security level will be increased.
The processing time will be longer (Approximately 140 minutes).
Follow the on-screen instructions.
After the reinstallation, the computer will restart.
- Do not interrupt installation, for example by turning off the computer or performing other operation.
Otherwise installation may become unavailable as Windows may not start up or the data may be corrupted.

2 Perform the “First-time Operation” (→ page 9).

NOTE

- The date and time, and the time zone may not be correct. Be sure to set them correctly.

3 Perform Windows Update.

Installing Software

■ Hard disk recovery

You can reinstall the OS that was pre-installed at the time of purchase (Windows 8.1 or Windows 7).

Windows 8.1 If reinstallation using the method described in “Remove everything and reinstall Windows” is not successful, follow the steps below.

Preparation

- Remove all peripherals.
- Connect the AC adaptor and do not remove it until installation is complete.

1 Start the Setup Utility.

Windows 8.1

- ① Display “Charm”, and click  - [Change PC settings] - [Update and recovery] - [Recovery].
- ② Click [Restart now] under “Advanced startup”.
- ③ Click [Troubleshoot] - [Advanced options] - [UEFI Firmware Settings] - [Restart].

Windows 7

Turn on the computer, and press **F2** or **Del** while [Panasonic] boot screen is displayed.

- If the [Panasonic] boot screen is not displayed, turn on the computer while holding down **F2** or **Del**.
- If the password is requested, enter the Supervisor Password.

2 Write down all of the contents of the Setup Utility and press **F9**.

At the confirmation message, select [Yes] and press **Enter**.

3 Check the [UEFI Boot] setting of the Setup Utility.

[UEFI Boot] should be set to as follows.

When installing Windows 8.1 : [Enabled]

When installing Windows 7 : [Disabled]

4 Press **F10**.

At the confirmation message, select [Yes] and press **Enter**.

Computer will restart.

5 Press **F2** or **Del** while [Panasonic] boot screen is displayed.

The Setup Utility starts up.

- If the password is requested, enter the Supervisor Password.

6 Select the [Exit] menu, then select [Recovery Partition] and press **Enter**.

Windows 8.1

Click [Next] and click [YES].

Windows 7

Click [Reinstall Windows] and click [Next].

8 At the License Agreement screen, click [Yes, I agree to the provisions above and wish to continue!] and click [Next].

9 Click [Next].

If the option is displayed, select the setting and click [Next].

- [Reinstall Windows to the whole Disk to factory default.]
Select this option when you want to install Windows to the factory default. After installation, you can create a new partition. For how to create a new partition, refer to “To change the partition structure” (→ page 10).
- [Reinstall to the OS related partitions.]^{*1}
Select this option when the hard disk has already been divided into several partitions and you want to keep the partition structure. For how to create a new partition, refer to “To change the partition structure” (→ page 10).

^{*1} This does not appear if Windows cannot be installed to the recovery partition and the area usable by Windows.

10 **Windows 7** At the confirmation message, click [YES].

Windows 7

Select language and system type (32bit or 64bit), then click [OK].

At the confirmation message, click [OK].

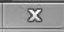
To cancel the recovery procedure, click [CANCEL], and click the  mark that appear the top right corner of the screen.

12 At the confirmation message, click [YES].

Installation starts according to the instructions on the screen. (It will take approximately 20 minutes.)

- Do not interrupt installation, for example by turning off the computer or performing other operation.
Otherwise installation may become unavailable as Windows may not start up or the data may be corrupted.

13 When Ending process screen is displayed, click [OK] to turn off the computer.

14 Turn on the computer.

- If the password is requested, enter the Supervisor Password.

NOTE

- **Windows 8.1** The date and time, and the time zone may not be correct. Be sure to set them correctly.

15 Start the Setup Utility and change the settings as necessary.**16 Perform Windows Update.****■ Using Recovery Disc**

Use the Recovery Disc in the following conditions.

- You have forgotten the administrator password.
- Installation is not complete. The recovery partition in the hard disk may be broken.
- **Windows 7** <Only for Windows 7 downgrade model>
To change OS from Windows 7 to Windows 8.1, or vice versa.

NOTE

- **Windows 7** To change OS from 32 bit to 64 bit, or vice versa, install OS using the recovery partition in the hard disk.

Preparation

- Prepare the following items:
 - Recovery Disc (→  *Reference Manual* “Recovery Disc Creation Utility”)
 - USB DVD drive (optional) (refer to recent catalogs and other sources for information about the products available)
- Remove all peripherals (except for the USB DVD drive).
- Connect the AC adaptor and do not remove it until installation is complete.

1 Connect the DVD drive to the USB port.**2 Start the Setup Utility.****Windows 8.1**

- ① Display “Charm”, and click  - [Change PC settings] - [Update and recovery] - [Recovery].
- ② Click [Restart now] under “Advanced startup”.
- ③ Click [Troubleshoot] - [Advanced options] - [UEFI Firmware Settings] - [Restart].

Windows 7

Turn on the computer, and press **F2** or **Del** while [Panasonic] boot screen is displayed.

- If the [Panasonic] boot screen is not displayed, turn on the computer while holding down **F2** or **Del**.
- If the password is requested, enter the Supervisor Password.

3 Write down all of the contents of the Setup Utility and press **F9.**

At the confirmation message, select [Yes] and press **Enter**.

4 Check the [UEFI Boot] setting of the Setup Utility.

[UEFI Boot] should be set to as follows.

When the recovery disc for Windows 8.1 is used : [Enabled]

When the recovery disc for Windows 7 is used : [Disabled]

5 Set the Recovery Disc into the DVD drive.**6 Press **F10**.**

At the confirmation message, select [Yes] and press **Enter**.

Computer will restart.

7 Press **F2 or **Del** while [Panasonic] boot screen is displayed.**

The Setup Utility starts up.

- If the password is requested, enter the Supervisor Password.

8 Select the [Exit] menu, then select your DVD drive in [Boot Override] and press **Enter.**

The computer will restart.

9 Click [Reinstall Windows] and click [Next].**10 **Windows 8.1** At the confirmation message, click [YES].****11 At the License Agreement screen, click [Yes, I agree to the provisions above and wish to continue!] and click [Next].**

12 **Windows 7**

Click [Next].

If the option is displayed, select the setting and click [Next].

- [Reinstall with HDD recovery partition.]
Standard recovery method.
You can use recovery from Recovery Partition.
- [Reinstall without HDD recovery partition.]
Increase usable HDD size.
You can NOT use recovery from Recovery Partition.
When this option is selected, you can no longer create Recovery Disc(s) after the recovery operation.

CAUTION

- Carefully choose above item because you cannot change it later.

13 Click [Next].

If the option is displayed, select the setting and click [Next].

- [Reinstall Windows to the whole Disk to factory default.]
Select this option when you want to install Windows to the factory default. After installation, you can create a new partition. For how to create a new partition, refer to "To change the partition structure" (→ page 10).
 - [Reinstall to the OS related partitions.]²
Select this option when the hard disk has already been divided into several partitions and you want to keep the partition structure. For how to create a new partition, refer to "To change the partition structure" (→ page 10).
- ² This does not appear if Windows cannot be installed to the recovery partition and the area usable by Windows.

14 At the confirmation message, click [YES].

15 **Windows 7**

Select language and system type (32bit or 64bit), then click [OK].

At the confirmation message, click [OK].

To cancel the recovery procedure, click [CANCEL], and click the  mark that appear the top right corner of the screen.

Windows 7 / **Windows 8.1**

Installation starts according to the instructions on the screen. (It will take approximately 30 - 45 minutes.)

- Do not interrupt installation, for example by turning off the computer or pressing **Ctrl** + **Alt** + **Del**.
Otherwise installation may become unavailable as Windows may not start up or the data may be corrupted.

16 When Ending process screen is displayed, remove the Recovery Disc and DVD Drive and then click [OK].

Follow the on-screen instructions.

Some models may take approximately 40 minutes.

17 Start the Setup Utility and change the settings as necessary.

18 Perform Windows Update.

Troubleshooting (Basic)







Follow the instructions below when a problem has occurred. There is also an advanced troubleshooting guide in the "Reference Manual". For a software problem, refer to the software's instruction manual. If the problem persists, contact Panasonic Technical Support. You can also check the computer's status in the PC Information Viewer (→  *Reference Manual* "Troubleshooting (Advanced)").

■ Starting Up



Cannot start up. The power indicator or battery indicator is not lit.	<ul style="list-style-type: none"> ● Connect the AC adaptor. ● Insert a fully charged battery. ● Remove the battery pack and the AC adaptor, then connect them again. ● If a device is connected to the USB port, disconnect the device, or set [USB Port] or [Legacy USB Support] to [Disabled] in the [Advanced] menu of the Setup Utility. ● If a device is connected to the ExpressCard slot, disconnect the device, or set [ExpressCard Slot] to [Disabled] in the [Advanced] menu of the Setup Utility. ● Press Fn + F8 to turn off the concealed mode. ● Check the [UEFI Boot] setting of the Setup Utility. [UEFI Boot] should be set to Windows 8.1 [Enabled] / Windows 7 [Disabled].
The power is turned on but "Warming up the system" appears.	<ul style="list-style-type: none"> ● The computer is warming up before start up. Wait for the computer to start up (the maximum waiting time will be displayed on the screen). If, "Cannot warm up the system" is displayed, the computer failed to warm up and does not start. In this case, turn off the computer, leave it in an environment of 5 °C or higher temperature for about an hour, and then turn on the power again.
Cannot turn on the computer. The computer does not resume from sleep. (The power indicator blinks alternately in orange and green.)	<ul style="list-style-type: none"> ● The computer is warming up. Wait a moment for warm-up to complete.
The computer does not enter sleep mode while the screen saver is running. (The screen stays black.)	<ul style="list-style-type: none"> ● Slide and hold the power switch for 4 seconds or longer to shut down the computer forcibly. (Data not saved will be lost.) Then disable the screen saver.
You have forgotten the password.	<ul style="list-style-type: none"> ● Supervisor Password or User Password: Contact Panasonic Technical Support. ● Administrator password: <ul style="list-style-type: none"> • If you have a password reset disk, you can reset the administrator password. Set the disk and enter any wrong password, then follow the on-screen instructions and set a new password. • If you do not have a password reset disk, reinstall (→ page 15) and set up Windows, and then set a new password.
"Remove disks or other media. Press any key to restart" or a similar message appears.	<ul style="list-style-type: none"> ● A floppy disk is in the drive and it does not contain system startup information. Remove the floppy disk and press any key. ● If a device is connected to the USB port, disconnect the device, or set [USB Port] or [Legacy USB Support] to [Disabled] in the [Advanced] menu of the Setup Utility. ● If a device is connected to the ExpressCard slot, disconnect the device, or set [ExpressCard Slot] to [Disabled] in the [Advanced] menu of the Setup Utility. ● If the problem persists after removing the disk, it may be a hard disk failure. Contact Panasonic Technical Support. ● Set [UEFI Boot] to [Disabled] in the [Boot] menu of the Setup Utility.
Windows startup and operation is slow.	<ul style="list-style-type: none"> ● Press F9 in the Setup Utility (→  <i>Reference Manual</i> "Setup Utility") to return the Setup Utility settings (excluding the passwords) to the default values. Start the Setup Utility and make the settings again. (Note that the processing speed depends on the application software, so this procedure may not make Windows faster.) ● If you installed a resident software after purchase, turn off the residence. ● Disable the pop-up menu and Input Panel Tab. <ol style="list-style-type: none"> ① Open the Input Panel, and click [Tools] - [Options] - [Opening]. ② Remove the check mark of [Show Input Panel sliding open from the tab] and click [OK].

Troubleshooting (Basic)

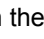

■ Starting Up

<p>The date and time are incorrect.</p>	<ul style="list-style-type: none"> ● Make the correct settings. <ol style="list-style-type: none"> ① Open the Control Panel. <div>Windows 8.1</div> <ol style="list-style-type: none"> 1. Perform either of the following procedures. <ul style="list-style-type: none"> • Right-click  at the bottom left corner of the Desktop screen. • Click  on the Start screen. 2. Click [Control Panel]. <div>Windows 7</div> <ol style="list-style-type: none"> Click  (Start) - [Control Panel]. ② Click [Clock, Language, and Region] - [Date and Time]. ● If the problem persists, the internal clock battery may need to be replaced. Contact Panasonic Technical Support. ● When the computer is connected to LAN, check the date and time of the server. ● The 2100 A.D. or later year will not be correctly recognized on this computer.
<p>[Executing Battery Recalibration] screen appears.</p>	<ul style="list-style-type: none"> ● The Battery Recalibration was canceled before Windows was shut down last time. To start up Windows, turn off the computer by the power switch, and then turn on.
<p>[Enter Password] does not appear when resuming from sleep/hibernation.</p>	<ul style="list-style-type: none"> ● Select [Enabled] in [Password On Resume] in the [Security] menu of the Setup Utility (→  <i>Reference Manual</i> "Setup Utility"). ● The Windows password can be used instead of the password set in the Setup Utility. <ol style="list-style-type: none"> ① Add a password. <div>Windows 8.1</div> <ol style="list-style-type: none"> 1. Display "Charm" and click  - [Change PC settings] - [Accounts]. 2. Click [Sign-in options], and click [Add] under "Password". <div>Windows 7</div> <ol style="list-style-type: none"> 1. Click  (Start) - [Control Panel]. 2. Click [User Accounts and Family Safety] - [Add or remove user accounts]. ② Set up the following. <div>Windows 8.1</div> <ol style="list-style-type: none"> 1. Open the Control Panel, click [System and Security] - [Power Options] - [Require a password on wakeup]. 2. Add a check mark for [Require a password]. <div>Windows 7</div> <ol style="list-style-type: none"> 1. Click [Control Panel] - [System and Security] - [Power Option] - [Require a password when the computer wakes] and add a check mark for [Require a password].
<p>Cannot resume.</p>	<ul style="list-style-type: none"> ● One of the following operations may have been carried out. Slide the power switch to turn on the computer. Data not saved will be lost. <ul style="list-style-type: none"> • In sleep mode, the AC adaptor or battery pack was disconnected, or a peripheral was connected or disconnected. • The power switch was slid for four seconds or longer to forcibly turn off the computer. ● An error may occur when the computer automatically enters the sleep or hibernation mode while the screensaver is active. In this case, turn off the screensaver or change the pattern of the screensaver.

■ Starting Up

Other startup problems.	<ul style="list-style-type: none"> ● Press F9 in the Setup Utility (→ <i>Reference Manual</i> "Setup Utility") to return the Setup Utility settings (excluding the passwords) to the default values. Start the Setup Utility and make the settings again. ● Remove all peripheral devices. ● Check to see if there was a disk error. <ol style="list-style-type: none"> ① Remove all peripheral devices including an external display. ② Windows 8.1 Perform either of the following procedures. <ul style="list-style-type: none"> • Right-click  at the bottom left corner of the Desktop screen. • Click  on the Start screen. ③ Windows 7 Click  (Start) - [Computer]. ④ Click [File Explorer]. ⑤ Right-click Windows 8.1 [Windows (C:)] / Windows 7 [Local Disk (C:)], and click [Properties]. ⑥ Click [Tools] - Windows 8.1 [Check] / Windows 7 [Check Now...]. <ul style="list-style-type: none"> • A standard user needs to enter an administrator password. ⑦ Follow the on-screen instructions. ● Windows 7 Start the computer in Safe Mode and check the error details. When the [Panasonic] boot screen disappears^{*1} at startup, press and hold F8 until the Windows Advanced Options Menu is displayed. Select the Safe Mode and press Enter. <p>^{*1} When [Password on boot] is set to [Enabled] in the [Security] menu of the Setup Utility, [Enter Password] appears after the [Panasonic] boot screen disappears. As soon as you enter the password and press Enter, press and hold F8.</p>
-------------------------	--

■ Entering Password





Even after entering the password, password input screen is displayed again.	<ul style="list-style-type: none"> ● The computer may be in ten-key mode. If the NumLk indicator  lights, press NumLk to disable the ten-key mode, and then input. ● The computer may be in Caps Lock mode. If the Caps Lock indicator  lights, press Caps Lock to disable the Caps Lock mode, and then input.
Cannot log on to Windows. ("The user name or password is incorrect." is displayed.)	<ul style="list-style-type: none"> ● The user name (account name) includes an "@" mark. <ul style="list-style-type: none"> - If another user account name exists: Log on to Windows using another user account name, and delete the account name that includes "@". Then create a new account name. - If no other account name exists: You need to reinstall Windows (→ page 15).

■ Shutting down



Windows does not shut down.	<ul style="list-style-type: none"> ● Remove the USB device and the ExpressCard. ● Wait one or two minutes. It is not a malfunction.
-----------------------------	---

Troubleshooting (Basic)

■ Display

No display.	<ul style="list-style-type: none"> The external display is selected. Press Fn + F3 or  + P to switch the display. Windows 7 Wait until the display has been switched completely before pressing Fn + F3 or  + P again. Windows 8.1 Then click the display mode. When using an external display, <ul style="list-style-type: none"> Check the cable connection. Turn on the display. Check the settings of external display. The display is turned off by the power-saving function. The screen returns to the original state when you operate keyboard or screen. When operating the keyboard, press a key that does not affect the computer operation, such as Ctrl. The computer entered sleep or hibernation by the power-saving function. To resume, slide the power switch.
The screen is dark.	<ul style="list-style-type: none"> The screen is darker when the AC adaptor is not connected. Press Fn + F2 and adjust the brightness. As you increase the brightness, battery consumption increases. You can separately set the brightness for when the AC adaptor is connected and when not connected. Press Fn + F8 to turn off the concealed mode.
The screen is disordered.	<ul style="list-style-type: none"> Changing the number of display colors and resolution may affect the screen. Restart the computer. Connecting/disconnecting an external display may affect the screen. Restart the computer. Resuming from sleep or hibernation may affect the screen of the external display. Restart the computer.
During Simultaneous display, one of the screens becomes disordered.	<ul style="list-style-type: none"> When using the Extended Desktop, use the same display colors for the external display as those used by the LCD. If you continue to experience problems, try changing the display. Right-click on the desktop, and click [Graphics Properties...] - [Display]. If you continue to experience problems, try changing the display. Simultaneous display cannot be used until Windows startup is complete (during Setup Utility, etc.).
The external display does not work normally.	<ul style="list-style-type: none"> If the external display does not support the power saving function, it may not work normally when the computer enters the power saving mode. Turn off the external display.
<Only for model with GPS> The pointer cannot be controlled properly.	<ul style="list-style-type: none"> Operate the following steps. <ol style="list-style-type: none"> Set [GPS] to [Disabled] in the [Advanced] - [Serial Port Settings] of the Setup Utility. Press F10 and select [Yes] at the confirmation message, and press Enter. The computer will restart. Log on to Windows as an administrator. Windows 8.1 <ol style="list-style-type: none"> Perform either of the following procedures. <ul style="list-style-type: none"> Right-click  at the bottom left corner of the Desktop screen. Click  on the Start screen. Click [Run], input "c:\util\drivers\gps\GPS.reg" then click [OK]. Windows 7 Click  (Start) and input "c:\util\drivers\gps\GPS.reg" in [Search programs and files], and press Enter. Click [Yes], click [Yes] and click [OK]. Then restart the computer. Press F2 while [Panasonic] boot screen is displayed. Set [GPS] to [Enabled] in the [Advanced] - [Serial Port Settings]. Press F10 and select [Yes] at the confirmation message, and press Enter.



■ Touch Pad / Touchscreen

The pointer does not work.	<ul style="list-style-type: none"> ● When using the external mouse, connect it correctly. ● Restart the computer using the keyboard. ● If the computer does not respond to keyboard commands, read “No response” (→ below).
Cannot input using the touch pad.	<ul style="list-style-type: none"> ● Set [Touch Pad] to [Enabled] in the [Main] menu of the Setup Utility. ● The drivers for some mice may disable the touch pad. Check your mouse’s operating instructions.
Cannot input using the touchscreen.	<ul style="list-style-type: none"> ● Set [Touchscreen Mode] to [Auto] or [Tablet Mode] in the [Main] menu of the Setup Utility. ● Set [Touchscreen] to [Enabled] in the [Advanced] menu of the Setup Utility.
Cannot point the correct position using the included stylus	<ul style="list-style-type: none"> ● Perform the touchscreen calibration (→  <i>Reference Manual</i> “Screen Input Operation”). ● Use the included stylus.
Windows 8.1 “Charm” does not always appear by finger operation.	<ul style="list-style-type: none"> ● Flick toward the center of the screen from the right edge or press and hold  (Enter) button. ● Use the included pen.

■ On-screen Document

Windows 7 The document of PDF format is not displayed.	<ul style="list-style-type: none"> ● Install Adobe Reader. <ol style="list-style-type: none"> ① Log on to Windows as an administrator. ② Click  (Start) and input “c:\util\reader\en\Pinstall.bat” in [Search programs and files] then press Enter. ③ Update Adobe Reader to its latest version. If your computer is connected to the internet, start up Adobe Reader and click [Help] - [Check for Updates...].
--	---

■ Others

No response.	<ul style="list-style-type: none"> ● Press Ctrl + Shift + Esc to open Task Manager and close the software application that is not responding. ● An input screen (e.g., password input screen at startup) may be hidden behind another window. Press Alt + Tab to check. ● Slide the power switch for four seconds or longer to shut down the computer, and then slide the power switch to turn it on. If the application program does not work normally, uninstall and reinstall the program. To uninstall, <ol style="list-style-type: none"> ① Open the Control Panel. <div> Windows 8.1 <ol style="list-style-type: none"> 1. Perform either of the following procedures. <ul style="list-style-type: none"> • Right-click  at the bottom left corner of the Desktop screen. • Click  on the Start screen. 2. Click [Control Panel]. </div> <div> Windows 7 <p>Click  (Start) - [Control Panel].</p> </div> <ol style="list-style-type: none"> ② Click [Program] - [Uninstall a program].
--------------	---

LIMITED USE LICENSE AGREEMENT

THE SOFTWARE PROGRAM(S) ("PROGRAMS") FURNISHED WITH THIS PANASONIC PRODUCT ("PRODUCT") ARE LICENSED ONLY TO THE END-USER ("YOU"), AND MAY BE USED BY YOU ONLY IN ACCORDANCE WITH THE LICENSE TERMS DESCRIBED BELOW. YOUR USE OF THE PROGRAMS SHALL BE CONCLUSIVELY DEEMED TO CONSTITUTE YOUR ACCEPTANCE OF THE TERMS OF THIS LICENSE.

Panasonic Corporation has developed or otherwise obtained the Programs and hereby licenses their use to you. You assume sole responsibility for the selection of the Product (including the associated Programs) to achieve your intended results, and for the installation, use and results obtained therefrom.

LICENSE

- A. Panasonic Corporation hereby grants you a personal, non-transferable and non-exclusive right and license to use the Programs in accordance with the terms and conditions stated in this Agreement. You acknowledge that you are receiving only a LIMITED LICENSE TO USE the Programs and related documentation and that you shall obtain no title, ownership nor any other rights in or to the Programs and related documentation nor in or to the algorithms, concepts, designs and ideas represented by or incorporated in the Programs and related documentation, all of which title, ownership and rights shall remain with Panasonic Corporation or its suppliers.
- B. You may use the Programs only on the single Product which was accompanied by the Programs.
- C. You and your employees and agents are required to protect the confidentiality of the Programs. You may not distribute or otherwise make the Programs or related documentation available to any third party, by time-sharing or otherwise, without the prior written consent of Panasonic Corporation.
- D. You may not copy or reproduce, or permit to be copied or reproduced, the Programs or related documentation for any purpose, except that you may make one (1) copy of the Programs for backup purposes only in support of your use of the Programs on the single Product which was accompanied by the Programs. You shall not modify, or attempt to modify, the Programs.
- E. You may transfer the Programs and license them to another party only in connection with your transfer of the single Product which was accompanied by the Programs to such other party. At the time of such a transfer, you must also transfer all copies, whether in printed or machine readable form, of every Program, and the related documentation, to the same party or destroy any such copies not so transferred.
- F. You may not remove any copyright, trademark or other notice or product identification from the Programs and you must reproduce and include any such notice or product identification on any copy of any Program.

YOU MAY NOT REVERSE ASSEMBLE, REVERSE COMPILE, OR MECHANICALLY OR ELECTRONICALLY TRACE THE PROGRAMS, OR ANY COPY THEREOF, IN WHOLE OR IN PART.

YOU MAY NOT USE, COPY, MODIFY, ALTER, OR TRANSFER THE PROGRAMS OR ANY COPY THEREOF, IN WHOLE OR IN PART, EXCEPT AS EXPRESSLY PROVIDED IN THE LICENSE.

IF YOU TRANSFER POSSESSION OF ANY COPY OF ANY PROGRAM TO ANOTHER PARTY, EXCEPT AS PERMITTED IN PARAGRAPH E ABOVE, YOUR LICENSE IS AUTOMATICALLY TERMINATED.

TERM

This license is effective only for so long as you own or lease the Product, unless earlier terminated. You may terminate this license at any time by destroying, at your expense, the Programs and related documentation together with all copies thereof in any form. This license will also terminate effective immediately upon occurrence of the conditions thereof set forth elsewhere in this Agreement, or if you fail to comply with any term or condition contained herein. Upon any such termination, you agree to destroy, at your expense, the Programs and related documentation together with all copies thereof in any form.

YOU ACKNOWLEDGE THAT YOU HAVE READ THIS AGREEMENT, UNDERSTAND IT AND AGREE TO BE BOUND BY ITS TERMS AND CONDITIONS. YOU FURTHER AGREE THAT IT IS THE COMPLETE AND EXCLUSIVE STATEMENT OF THE AGREEMENT BETWEEN US, WHICH SUPERSEDES ANY PROPOSAL OR PRIOR AGREEMENT, ORAL OR WRITTEN, AND ANY OTHER COMMUNICATIONS BETWEEN US, RELATING TO THE SUBJECT MATTER OF THIS AGREEMENT.

Specifications

This page provides the specifications for the basic model.

The model number is different according to the unit configuration.

- To check the model number:
Check the bottom of the computer or the box the computer came in at the time of purchase.
- To check CPU speed, memory size and the hard disk drive (HDD) size:
Run the Setup Utility (→  *Reference Manual* "Setup Utility") and select [Information] menu.
[Processor Speed]: CPU speed, [Memory Size]: Memory size, [Hard Disk]: Hard disk drive size

■ Main Specifications

CPU/Secondary cache memory		Intel® Core™ i5-3610ME Processor (3 MB ^{*1} cache, 2.7 GHz up to 3.3 GHz) with Intel® Turbo Boost Technology
Chip Set		Mobile Intel® 7 QM77 Express Chipset
Video controller		Intel® HD Graphics 4000 (Built-in CPU)
Main Memory ^{*2}		4 GB ^{*1} , DDR3L SDRAM (8 GB ^{*1} Max.)
Storage		Hard Disk Drive : 500 GB ^{*3} / Flash Memory Drive : 128 GB ^{*3} / 256 GB ^{*3} Windows 8.1 Approx. 15 GB ^{*3} is used as a partition with HDD recovery tools. (Users cannot use this partition.) Approx. 1 GB ^{*3} is used as a partition with system tools. (Users cannot use this partition.) Windows 7 Approx. 50 GB ^{*3} is used as a partition with HDD recovery tools. (Users cannot use this partition.) Approx. 300 MB ^{*3} is used as a partition with system tools. (Users cannot use this partition.)
Display Method		10.1 XGA type (TFT) (1024 × 768 dots)
	Internal LCD	65,536 / 16,777,216 colors (800 × 600 dots / 1024 × 768 dots) ^{*4}
	External Display ^{*5}	65,536 / 16,777,216 colors (800 × 600 dots / 1024 × 768 dots / 1280 × 768 dots / 1280 × 1024 dots)
Wireless LAN ^{*6}		Intel® Centrino® Advanced-N 6235 (a/b/g/n) → page 26
Bluetooth ^{*7}		→ page 26
GPS ^{*8}		Chip: u-blox NEO-M8N Accuracy: 4.8 m (2DRMS, SBAS) Protocol message: NMEA Version 4.0
LAN		IEEE 802.3 10Base-T / IEEE 802.3u 100BASE-TX / IEEE 802.3ab 1000BASE-T
Modem ^{*9}		Data: 56 kbps (V.92) FAX: 14.4 kbps
Sound		WAVE and MIDI playback, Intel® High Definition Audio subsystem support
Card Slot	PC Card Slot	x 1, Type I or Type II, Allowable current 3.3 V: 400 mA, 5 V: 400 mA
	ExpressCard Slot ^{*10}	x 1, ExpressCard/34 or ExpressCard/54
	SD Memory Card Slot ^{*11}	x 1
	Contact Smart Card Slot ^{*12}	x 1
RAM Module Slot		DDR3L SDRAM, 204-pin, 1.35 V, SO-DIMM, PC3-10600 Compliant
Interface		USB Ports x 2 (USB 2.0 x 1 + USB 3.0 x 1) ^{*13} / Serial Port (Dsub 9-pin male) / Modem Port (RJ-11) ^{*9} / LAN Port (RJ-45) / VGA Port (Mini Dsub 15-pin female) / IEEE1394a Interface Connector (4-pin) ^{*14} / Microphone Jack (Miniature jack, 3.5 DIA) / Headphone Jack (Miniature jack, 3.5 DIA, Impedance 32 Ω, Output Power 4 mW × 2, Stereo) / Expansion Bus Connector (Dedicated 100-pin female), External Antenna Connector (Dedicated 50 W coaxial connector) x 2
Keyboard / Pointing Device		82 or 83 keys / Touch Pad / Touchscreen (Anti-Reflection, Stylus (included) touch capable)
Camera ^{*15}		1280 x 720 dots, 30 fps (Video) 2048 x 1536 dots, 15 fps (Video) 2592 x 1944 dots (still)
Power Supply		AC adaptor or Battery pack
AC Adaptor ^{*16}		Input: 100 V - 240 V AC, 50 Hz/60 Hz, Output: 15.6 V DC, 7.05 A
Battery Pack		Li-ion 10.65 V, Typical 5700 mAh / Minimum 5400 mAh
	Operating Time ^{*17}	Approx. 10 hours
	Charging Time ^{*18}	Approx. 3.5 hours
Power Consumption ^{*19}		Approx. 30 W ^{*20} / Approx. 90 W (maximum when recharging in the ON state)

Specifications

■ Main Specifications

Physical Dimensions (W × D × H) (including the carrying handle)			271 mm × 216 mm × 49 mm
Weight (including the hand strap)			Approx. 2.30 kg
Environment	Operating	Temperature	-10 °C to 50 °C (IEC60068-2-1, 2) ^{*21}
		Humidity	30 % to 80 % RH (No condensation)
	Storage	Temperature	- 20 °C to 60 °C
		Humidity	30 % to 90 % RH (No condensation)

■ Software

Base OS	Windows® 8.1 Pro Update 64-bit
Installed OS ^{*22}	Windows 8.1 Windows® 8.1 Pro Update 64-bit Windows 7 Windows® 7 Professional 32-bit Service Pack 1 (downgraded to Windows® 7) ^{*23} / Windows® 7 Professional 64-bit Service Pack 1 (downgraded to Windows® 7) ^{*23}
Pre-installed Software	Adobe Reader, PC Information Viewer, Intel® PROSet/Wireless Software ^{*6} , Intel® PROSet/Wireless Software for Bluetooth® Technology ^{*7} , Hotkey Settings, Battery Recalibration Utility, PC-Diagnostic, Hard Disk Data Erase Utility ^{*25} , Recovery Disc Creation Utility, Dashboard for Panasonic PC, Power Plan Extension Utility, Camera Utility ^{*15} , Camera Light Switch Utility ^{*15} , GPS Viewer ^{*8} , Manual Selector, Microsoft Office Trial ^{*26} , Display Rotation Tool Windows 8.1 Camera for Panasonic PC, Wireless Toolbox Windows 7 Wireless Switch Utility, Wireless Connection Disable Utility ^{*6 *8 *24} , Quick Boot Manager, Bluetooth® Stack for Windows® by Toshiba

■ Wireless LAN^{*6}

Data Transfer Rates ^{*27}	IEEE802.11a : 54 Mbps IEEE802.11b : 11 Mbps IEEE802.11g : 54 Mbps IEEE802.11n : HT20 : 150 Mbps HT40 : 300 Mbps
Standard Supported	IEEE802.11a / IEEE802.11b / IEEE802.11g / IEEE802.11n
Transmission Method	OFDM system, DSSS system

■ Bluetooth®^{*7}

Bluetooth Version	Version 4.0
	Classic mode / Low Energy mode
Transmission method	FHSS system
Wireless Channels Used	Channels 1 to 79 / Channels 0 to 39
RF Frequency Band	2.402 GHz - 2.480 GHz

^{*1} 1 MB = 1,048,576 bytes / 1 GB = 1,073,741,824 bytes

^{*2} Memory size of the factory default depends on the model. You can physically expand the memory up to 8 GB, but the total amount of usable memory available will be less depending on the actual system configuration.

^{*3} 1 MB = 1,000,000 bytes / 1 GB = 1,000,000,000 bytes. Your operating system or some application software will report as fewer GB.

^{*4} A 16,777,216 color display is achieved by using the dithering function.

^{*5} Display may be impossible using some connected external displays.

^{*6} Only for model with wireless LAN.

^{*7} Does not guarantee operation of all Bluetooth peripherals.

^{*8} Only for model with GPS.

^{*9} Only for model with modem.

^{*10} Only for model with ExpressCard slot.

^{*11} This slot is compatible with High-Speed Mode. Operation has been tested and confirmed using Panasonic SD/SDHC/SDXC Memory Cards with a capacity of up to 64 GB. Operation on other SD equipment is not guaranteed.

^{*12} Only for model with Smart Card slot.

^{*13} Does not guarantee operation of all USB-compatible peripherals.

^{*14} Only for model with IEEE 1394a interface.

^{*15} Only for model with Camera. The specifications may differ depending on the model.

- ^{*16} <Only for North America>
The AC adaptor is compatible with power sources up to 240 V AC adaptor. This computer is supplied with a 125 V AC compatible AC cord. 20-M-2-1
- ^{*17} Measured with LCD brightness : 60 cd/m²
Varies depending on the usage conditions, or when an optional device is attached.
- ^{*18} Varies depending on the usage conditions, CPU speed, etc.
- ^{*19} Approx. 0.9 W when the battery pack is fully charged (or not being charged) and the computer is off.
<When using with 115 V / 230 V AC>
Even when the AC adaptor is not connected to the computer, power is consumed (Max. 0.15 W) simply by having the AC adaptor plugged into an AC outlet.
- ^{*20} Rated power consumption. 23-E-1
- ^{*21} Do not expose the skin to this product when using the product in a hot or cold environment. (➔ OPERATING INSTRUCTIONS - Read Me First) When using in hot or cold environment, some peripherals may fail to work properly. Check the operation environment of the peripherals.
Using this product continuously in a hot environment will shorten the product life. Avoid use in these types of environments.
When using in low temperature environment, startup may become slow or battery operation time may become short.
The computer consumes power when the hard disk is warming up during startup. Therefore, if you are using battery power and the remaining power is low, the computer may not start up.
- ^{*22} Operations of this computer are not guaranteed except for the pre-installed OS and the OS which is installed by using the Recovery disc provided by Panasonic.
- ^{*23} This system is preinstalled with Windows® 7 Professional software and also comes with a license for Windows 8.1 Pro software. You may only use one version of the Windows software at a time. Switching between versions will require you to uninstall one version and install the other version.
- ^{*24} Must be installed before use.
- ^{*25} Perform on the recovery disc.
Windows 7
Alternatively perform on the hard disk recovery partition.
- ^{*26} To continue using this software after the end of the trial, purchase a license by following the on-screen instructions.
- ^{*27} Maximum data transfer rates of wireless LAN standards.
Actual speeds may differ.



As an ENERGY STAR® Partner, Panasonic Corporation has determined that this product meets the ENERGY STAR® guidelines for energy efficiency. By enabling available power management settings, Panasonic computers enter a low-power sleep mode after a period of inactivity, saving the user energy.

<For U.S.A.>

To learn more about power management, please visit the web site:

www.energystar.gov/index.cfm?c=power_mgt.pr_power_management

Outline of the International ENERGY STAR® Office Equipment Program

The international ENERGY STAR® Office Equipment Program is an international program that promotes energy saving through the use of computers and other office equipment. The program backs the development and dissemination of products with functions that effectively reduce energy consumption. It is an open system in which business proprietors can participate voluntarily. The targeted products are office equipment such as computers, displays, printers, facsimiles, and copiers. Their standards and logos are uniform among participating nations.

<For U.S.A.>

For information about ENERGY STAR®, refer to the following web site:

Web Site: www.energystar.gov

22-E-1

Panasonic Corporation

Osaka, Japan

Panasonic System Communications Company of North America

Two Riverfront Plaza

Newark, NJ 07102

Panasonic Canada Inc.

5770 Ambler Drive Mississauga,

Ontario L4W 2T3

Panasonic Australia Pty. Limited

ACN 001 592 187 ABN 83 001 592 187

1 Innovation Road, Macquarie Park NSW 2113

Importer's name & address pursuant to the EU legislation

Panasonic System Communications Company Europe, Panasonic Marketing Europe GmbH

Hagenauer Straße 43

65203 Wiesbaden

Germany

Web Site : <http://panasonic.net/avc/pc/>

55-E-1

パナソニック株式会社 ITプロダクツ事業部

〒 570-0021 大阪府守口市八雲東町一丁目 10 番 12 号